

# SuperReel CATENARY SYSTEM

V.LOCK and ZedFast work together to create a complete catenary system

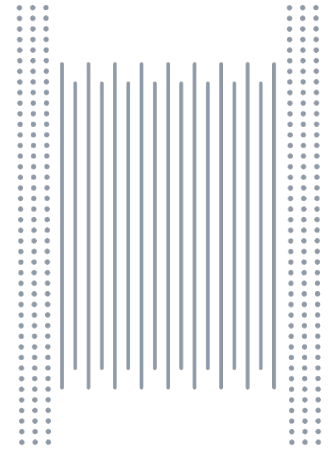

Code	Product Description
S100	SuperReel 2mm galvanised 100m, 10 locations
S250	SuperReel 2mm galvanised 250m, 30 locations
S500	SuperReel 2mm galvanised 500m, 50 locations
SE25	SuperReel 2mm galvanised expansion pack, 25 locations

## Technical Information

- No tools required – adjust by hand
- Simple to use
- Ball bearing locking system onto the wire
- High tensile, pre-stretched  
2mm (3/32”) wire rope

**Free  
Span  
Load  
Rating  
(5:1) :  
56kg**

## Applications

Suitable for suspending:

- Lightweight Electrical Services
- Data Cable
- Lightweight Ductwork
- Signage

## Installation

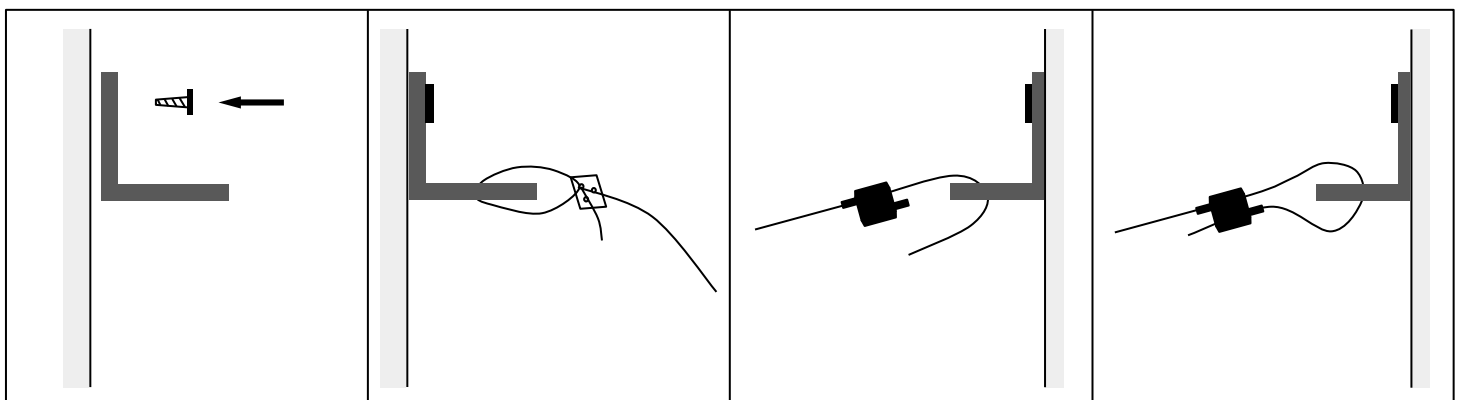

**Step 1**  
Screw 90° bracket  
into wall

**Step 2**  
Attach wire to one end  
with **V.LOCK** plate

**Step 3**  
Cut other end to length,  
attach **ZedFast**, and loop  
through 90° bracket

**Step 4**  
Back through **ZedFast**  
and pull to tighten